

Memo

Date 1 October 2020

To: Phill Reid, Auckland-wide Manager
From: Megan Patrick Team Leader Heritage Policy

Subject: **Plan Modification: Clause 20A Amendment to the planning maps of the Auckland Unitary Plan (AUP) Operative in part (15 November 2016).**

Delegated authority to T4 manager through Schedule 2A of the Auckland Council Combined Chief Executives Delegation Register (Updated May 2017).

This plan modification requires decision-making pursuant to clause 20A of the First Schedule to the Resource Management Act 1991, as corrections are required to the Auckland Unitary Plan (Operative in Part).

Rule or Section of Unitary Plan	Planning maps
Subject Site (if applicable)	12A The Avenue, Albany
Legal Description (if applicable)	Lot 2 DP 466595
Nature of change	<p>Amend the planning maps for 12A The Avenue, Albany to remove the historic heritage overlay from this property in the Operative in Part version.</p> <p>Discussion</p> <p>The property at 12 The Avenue, Albany is subject to the historic heritage overlay (UP ID#0850). This overlay does not align with the property boundary.</p> <p>In error, a small portion of overlay is identified on the neighbouring property of 12A The Avenue, Albany. The overlay on this property is to be deleted.</p>
Effect of change	The property at 12A The Avenue, Albany does not have identified heritage values. The overlay is not required and was not intended to be placed on this property.

Changes required to be made

Amend the planning maps for 12A The Avenue, Albany to remove the historic heritage overlay from this property in the Operative in Part version.

Subject property is outlined in blue, below. Purple hatching, being the historic heritage overlay, is to be removed from the subject property.

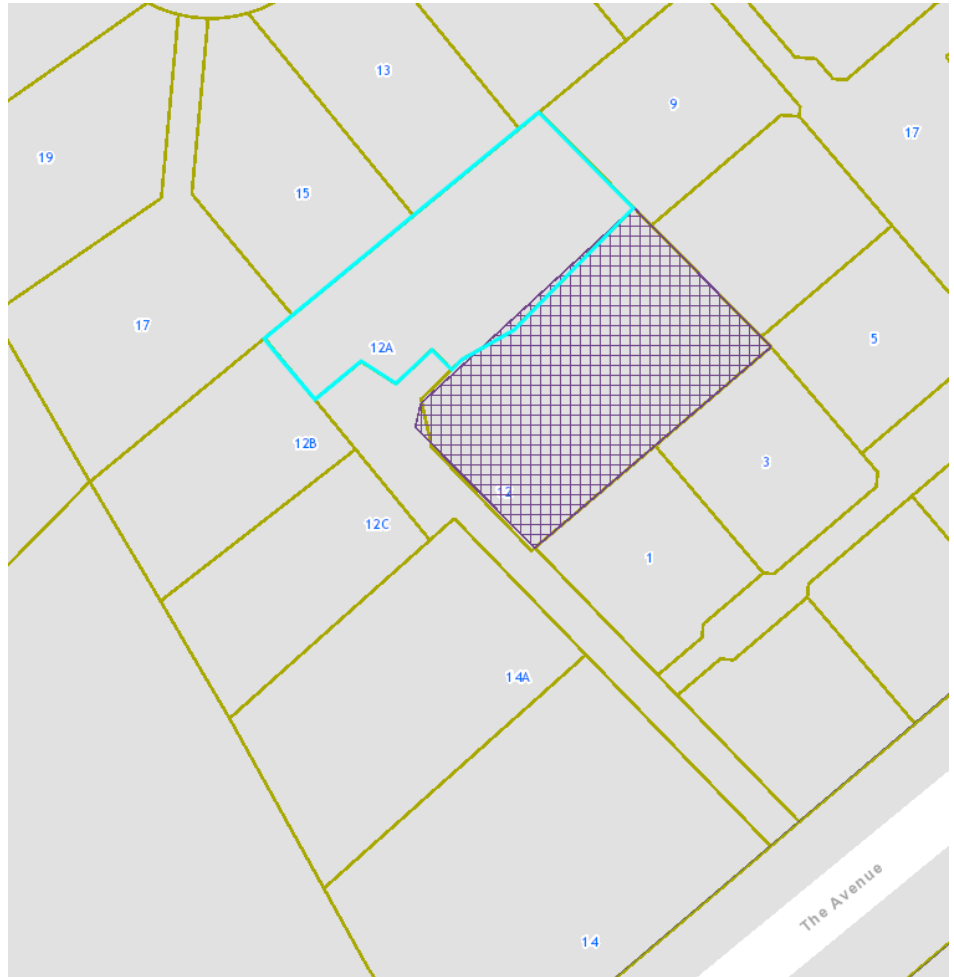

Prepared by:
Megan Patrick

Approved by:
Noel Reardon



Signature:

Signature:

Updated GIS Viewer

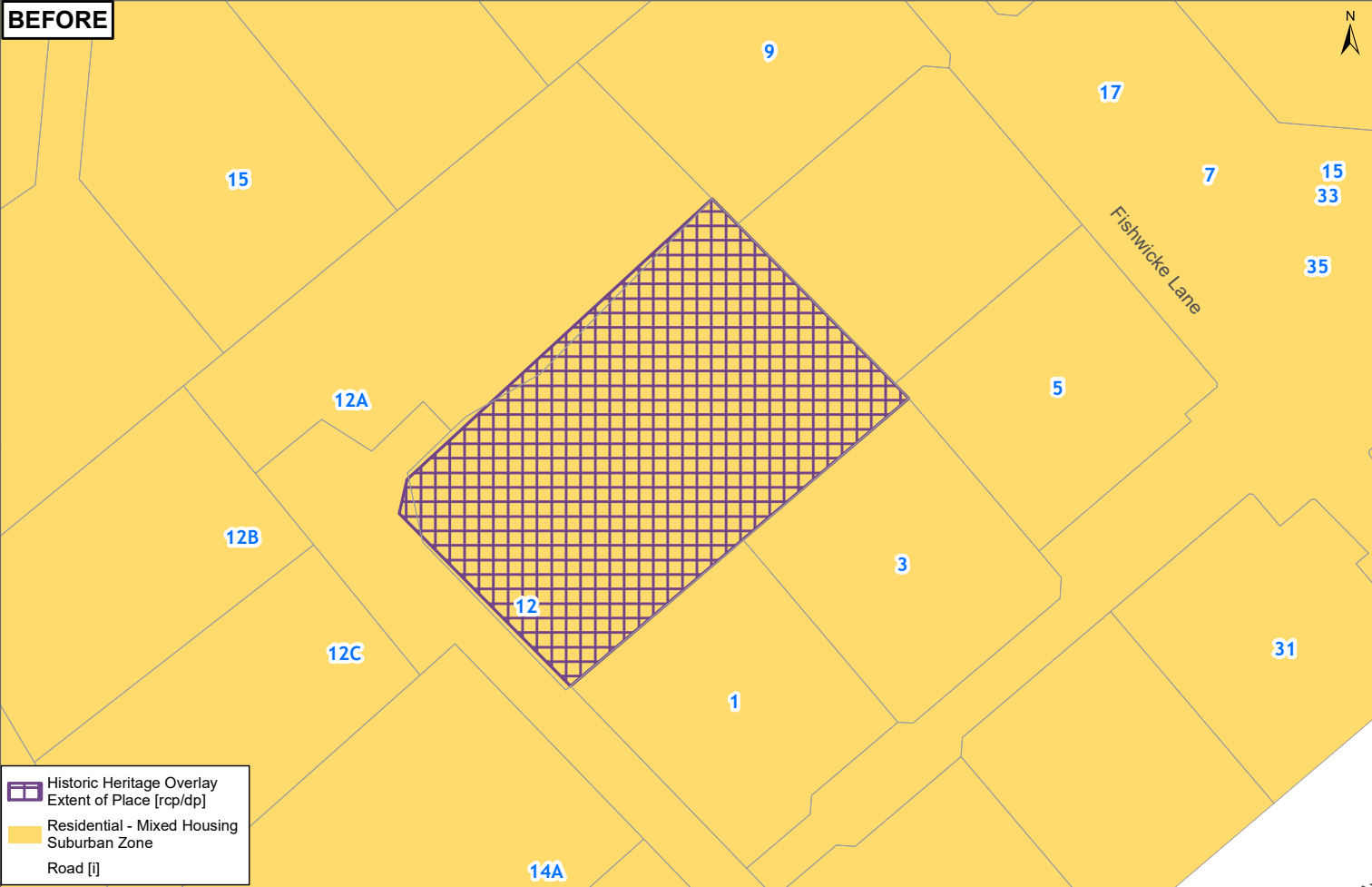

BEFORE

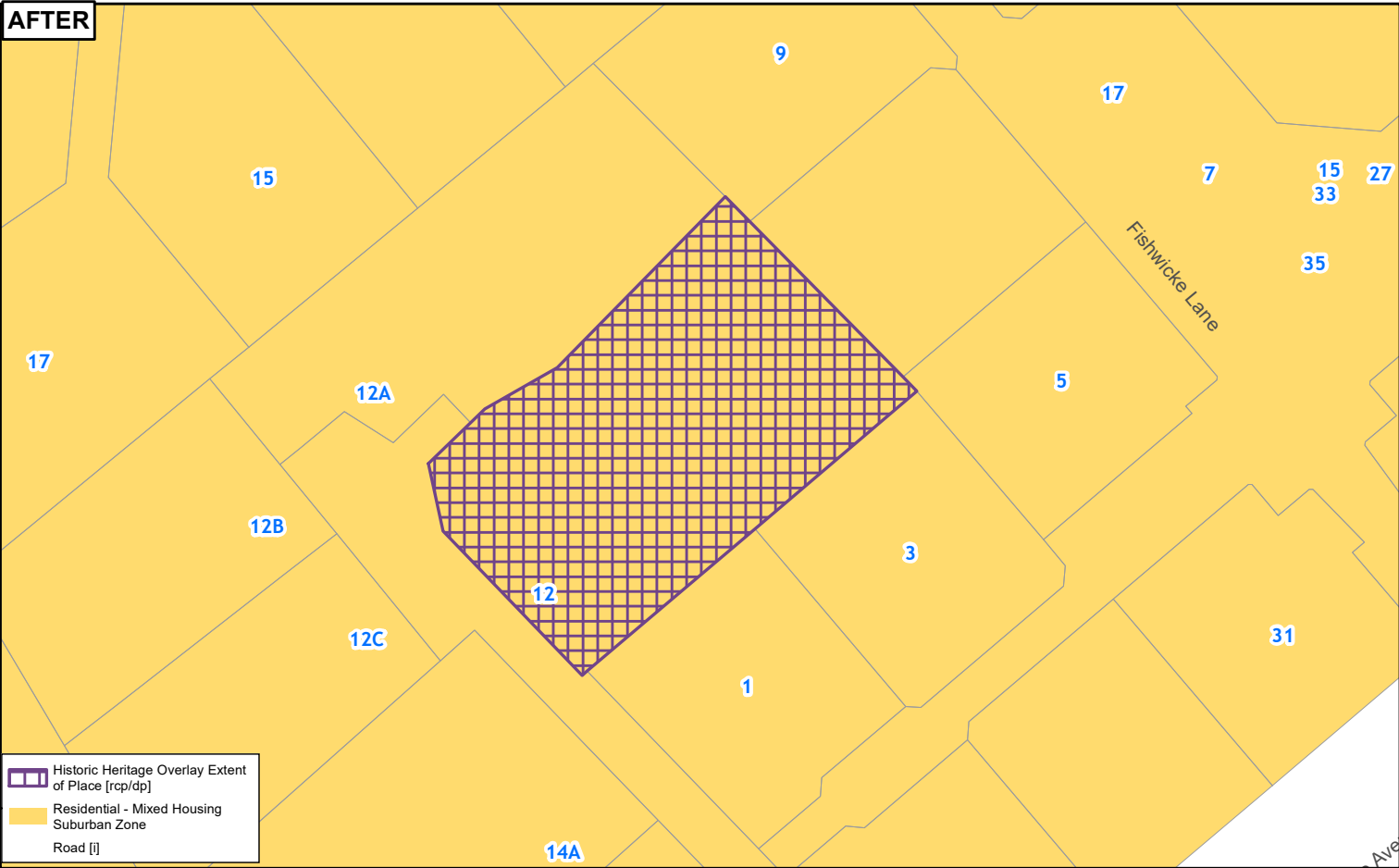

 Historic Heritage Overlay
 Extent of Place [rcp/dp]
 Residential - Mixed Housing
 Suburban Zone
 Road [i]

AFTER



 Historic Heritage Overlay Extent
 of Place [rcp/dp]
 Residential - Mixed Housing
 Suburban Zone
 Road [i]

0 4 8 16 Metres
 Whilst due care has been taken, Auckland Council gives no warranty as to the accuracy and completeness of any information on this map/plan and accepts no liability for any error, omission or use of the information.
 Date: 9/11/2020

**Historic Heritage overlay extent updated
12A the Avenue, Albany**

 Te Kaunhera o Tāmaki Makaurau
 Plans and Places